

ADAPTATION ASSEMBLY INSTRUCTIONS

AmTryke[®]

The therapeutic tricycle for people with disabilities

For questions or to place an order, please contact:

Amtryke, LLC.
(800) 838-1845 x114
amtryke@ambucs.org
www.ambucs.org

ProSeries Model 1412 & Rear Steering Kit

Part #: 50-FC-1412 & Part #: 50-FC-1512



What's inside: Carefully remove and lay out all parts from the carton so as not to scratch or lose any parts or pieces. The following is included in your package—pedal box (pd-v3 ½ inch), saddle seat assembly, part box, and main frame assembly.

Tools Needed for Assembly: 8mm socket/wrench, 10mm socket/wrench, 13mm socket and wrench, 14mm socket and wrench, 15mm socket and wrench, needle nose pliers, and utility knife.

Step 1: Front Fork to Main Frame Assembly. To mount front fork onto main frame:

- A) Slide one of the ball bearings retainers onto the front wheel fork tube with ball bearings facing up. Then insert the fork tube into the main frame tube.
- B) Slide the second ball bearing retainer onto the top of the fork tube. The ball bearings face down and seat into the chrome ring in the main frame.
- C) Screw the head cup onto the threaded top of the fork tube. Tighten this but do not over tighten. The fork assembly should be snug with no play, but it should allow for easy turning movement.
- D) The lock washer is installed next—install it into the top of the fork tube. Be sure the tab in the washer is inserted into the slot in the fork tube.
- E) Finally, install lock nut onto the fork tube. It threads onto the fork tube. Tighten securely.

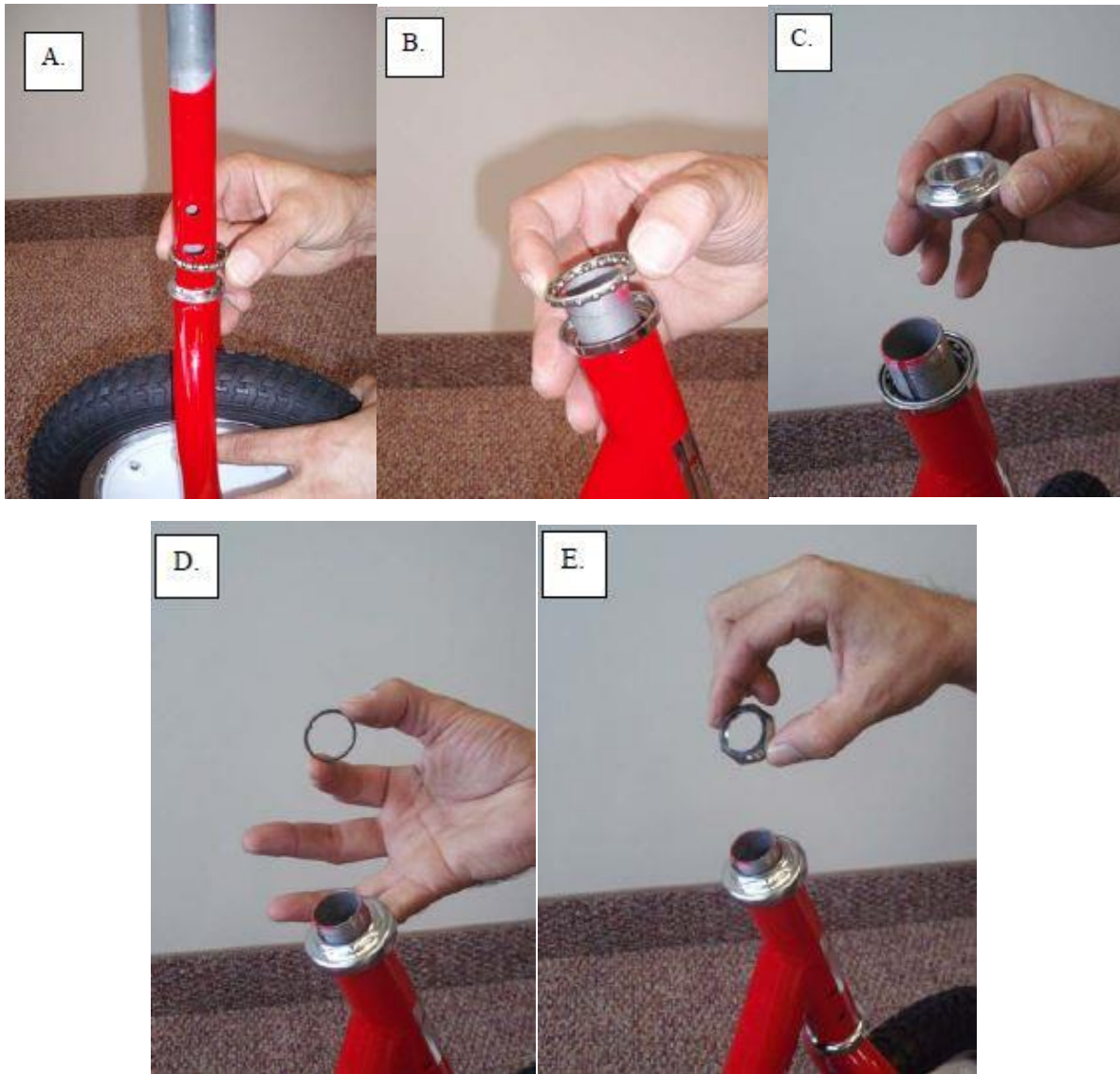

Step 2: Load Lock Brake. Remove the two Allen bolts from the base of the load lock brake.

A) Place the load lock brake over the right side of the rear axle housing. Align the two holes in the load lock brake bracket with the two holes of the bracket attached to the right rear axle housing.

B) The chrome metal piece of the load lock brake should be over top of the right rear tire.

C) Install the two Allen head bolts from the bottom going upwards into the load lock brake. Tighten down the load lock brake securely.

CAUTION: Always engage the brake when transferring a rider on or off the tryke!

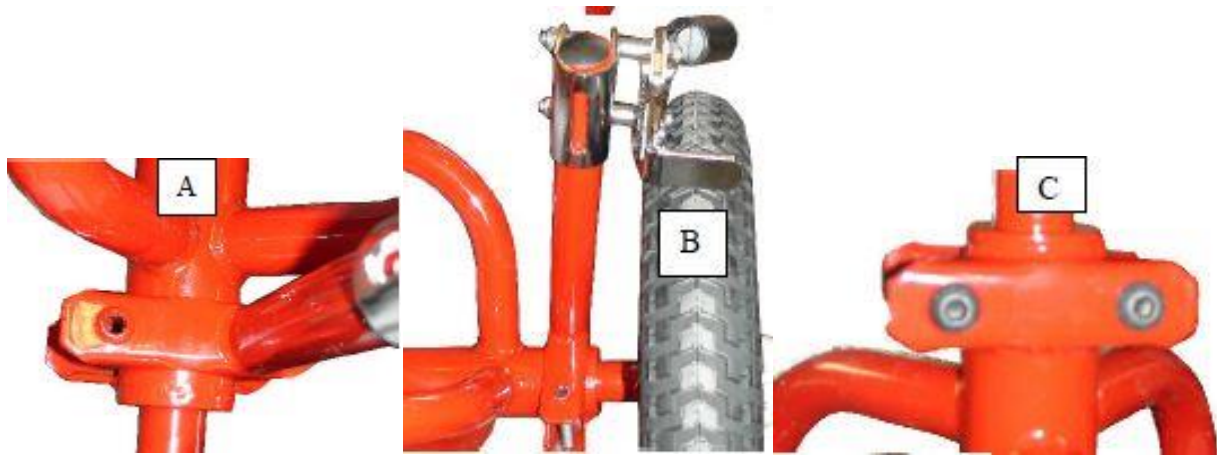

Step 3: Handlebar and Stem.

A) Remove black plastic cap from handle bar stem. Insert stem of handlebar assembly into fork head tube. Note: The stem must be inserted into the fork head tube to at least the minimum insertion line.

B) Secure stem by tightening stem expander hex head bolt using a 6mm Allen wrench (included). Be sure to center stem with the front wheel.

C) Replace gray plastic cover.

D) Tighten 2 hex head screws at top of stem to tighten handlebar clamp.

E) Use quick release locking cam levers to adjust handle bar position and tighten securely.

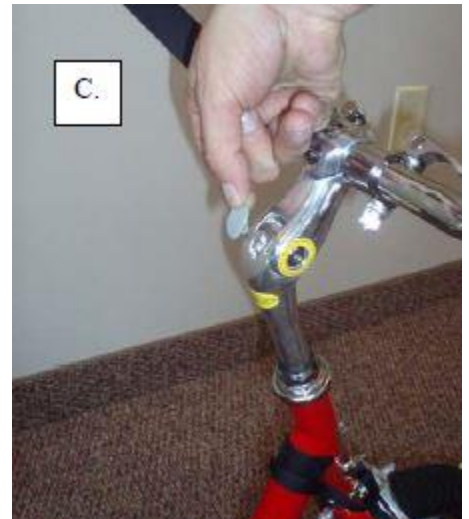
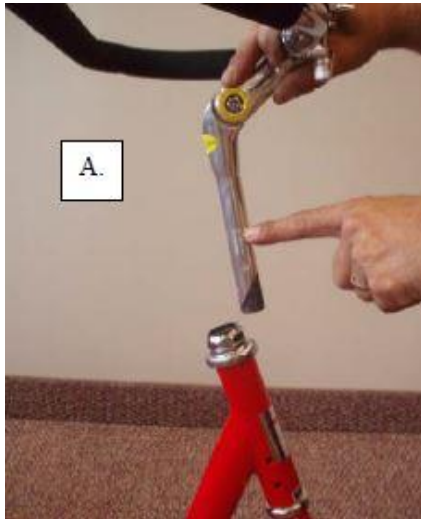



Step 4: Seat Post Frame Assembly.

A) Place the red seat post bracket on the frame rail and from the underside place the plate and install one securing knob at a time with washer until tight.

B) The seat post can be positioned along the frame rail, forward and backward by loosening the two securing knobs located on the underside of the seat post plate. See direction "A".

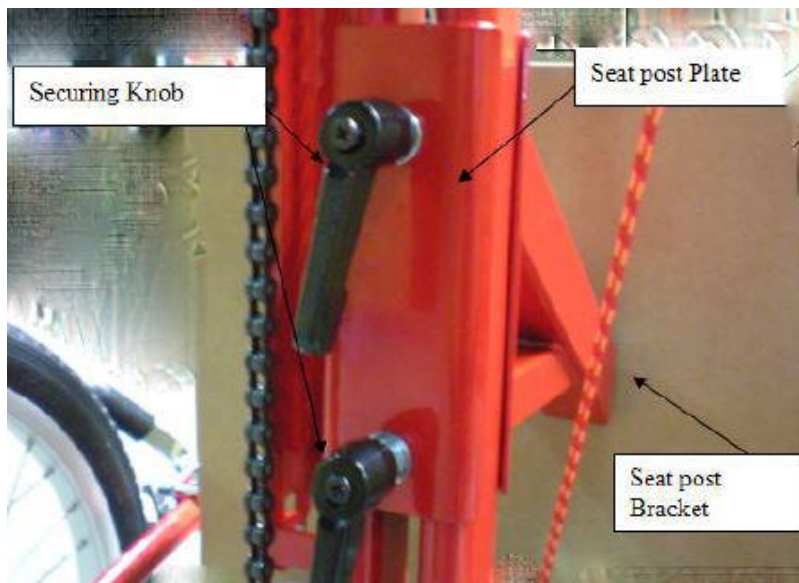



Step 5: Seat Post.

Slide seat assembly into the slanted tube on main frame. Pull back on spring loaded knob and let pin seat into desired hole on seat assembly. Note: Seat post knob is does not need to be removed. Simply loosen, pull out on spring loaded knob, and then tighten once pin is in desired hole position.



Step 6: Basket Assembly. Mount the black basket bracket onto the rear bar of the frame behind the seat using 1 ¼" bolts with nuts and washers. The bracket is mounted from the bottom of frame bar. Insert bolt and washer from top and place washer and nut on end of bolt—tighten.



Step 7: Bars at rear of basket mount onto bracket at back of tryke. Two screws and nuts (black) can secure basket if rider desires permanent attachment.

Revised Date: 4/22/2016

n:\amtryke\manuals and instructions - 2016\models\1412\proseries model 1412 with rear steering.docx

Step 8: Pedals. Note: There is a right and left pedal indicated by an L or R on the end of each pedal axle.

A) Mount pedals onto crank. Left pedal tightens left. Right pedal tightens right. Use 15mm wrench to tighten.

B) Note: Be careful when threading pedals. Do not force!! Pedals thread easily when installed properly.



Step 9: Steering Pin Installation.

A) The steering pin inserts into the front fork tube from the side.

B) The top position locks the steering straight. This allows for easy transfer or if the child needs assistance with learning to steer properly.

C) The lower position limits the steering to 20 degrees in either direction. This is very helpful in limiting the turning radius of the tryke. It keeps a rider from over steering and adds to safe riding.

D) Install the adhesive hook strip to the frame to keep the steering pin secure from loss.

Step 10: Quick Release Wrench.

A) The quick release wrench is included (black tube with one end crimped and one end slotted). As seen in step 3, figure E.

B) This is useful for gaining leverage to insure quick release locking cam levers are tightened securely.

ProSeries 1412 Rear Steer Kit

Part #: 30-50-1512

Tools Needed: 10mm wrench or socket, 13mm wrench or socket, 6mm Allen/Hex wrench.

- A) Using the 6mm Allen/Hex wrench, loosen the two Allen bolts that are found on the rear steering collar.
- B) Insert the steering bar into the collar; do not tighten Allen bolts at this time.
- C) Attach steering control bar to rear of the 1512 as shown in diagram.
- D) Attach the steering bar to the front of 1412 as shown in the diagram.
- E) Adjust front wheel to point straight ahead and then tighten the 6mm Allen bolts for the steering collar—making sure that the steering handle is also straight as you tighten bolts.
- F) Attach brake cable to brake lever located on steering bar. Brake cable runs through eyelets located on steering control bar.
- G) Attach brake cable to front brake and adjust.



Questions or Concerns Regarding your Build? No problem! Please Contact Derek Shaw, AmTryke Technical and Customer Support Coordinator @ 1-800-838-1845 x114 or dereks@ambucs.org